

# 780.3.201

## Brushless motor (Diameter $\Phi$ 83mm)

# DOMEL®

The main advantage of electronically commutated brushless motors is maintenance free operation combined with high efficiency. The high efficiency help to reduce the energy costs of the complete system. A high efficient brushless motor uses about a third less energy as conventional AC motor.

For high speed brushless motor an inner rotor is used. In 780 series is used stator with diameter  $\phi$  83 mm, which is suitable for various high-speed applications. For different usage we can modify: housing, flange, sealing and protection of the motor, shaft, speed regulation and complete design up to customer request. We have capabilities to modify also the cooling of the motor, which could be achieved in various options.

Domel can custom design and manufacture brushless motors on your specific requirements incorporating the latest technologies. We are experienced to offer development for different brushless solutions.

Main brushless motors advantages are:

- High efficiency
- High Torque/ Volume ratio
- Long Life
- Low noise

OTHER CUSTOM-DESIGN SOLUTIONS UP ON YOUR REQUEST !!  
"PLEASE CONTACT US"

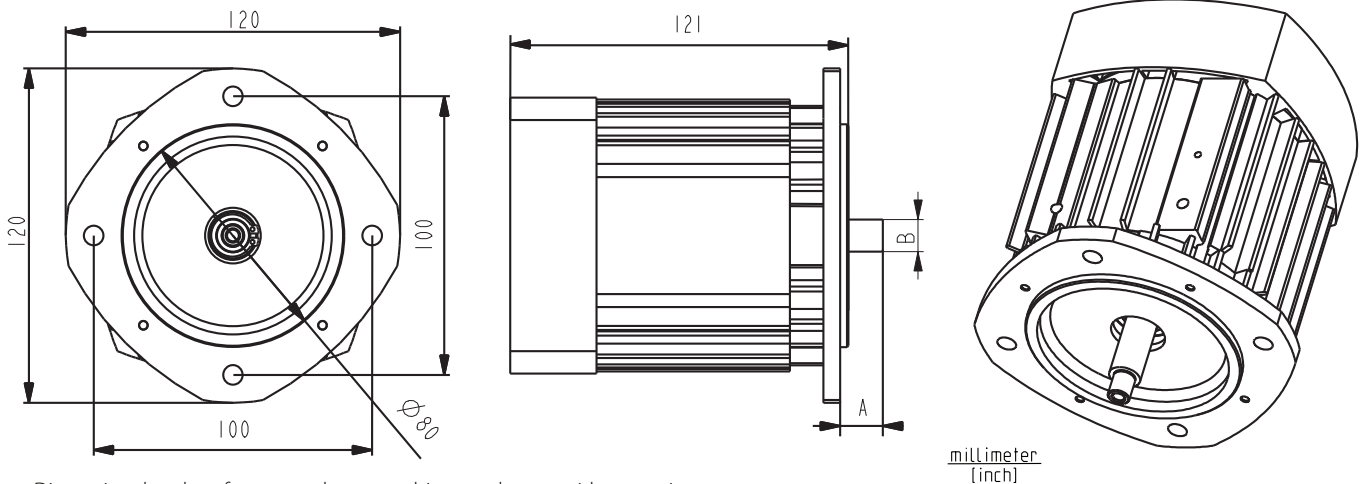

Dimensional and performance data are subject to change without notice.

I	P <sub>1</sub>	M	n	P <sub>2</sub>	Eta
[A]	[W]	[Ncm]	[min <sup>-1</sup> ]	[W]	[%]
2,99	393,46	4,01	39888	167,33	42,50
3,91	540,94	7,99	38003	317,98	58,80
4,77	681,99	12,01	36217	455,50	66,80
5,51	809,02	16,04	34683	582,57	72,00
6,26	932,90	20,01	33060	692,75	74,30
6,94	1033,67	24,00	31362	788,21	76,30
7,52	1122,36	28,00	29694	870,67	77,60
8,09	1203,56	32,01	28056	940,46	78,10

Data above represent the performance of an average motor sample. Individual data may vary due to normal manufacturing variations.

## 780.3.201 – Performance diagram

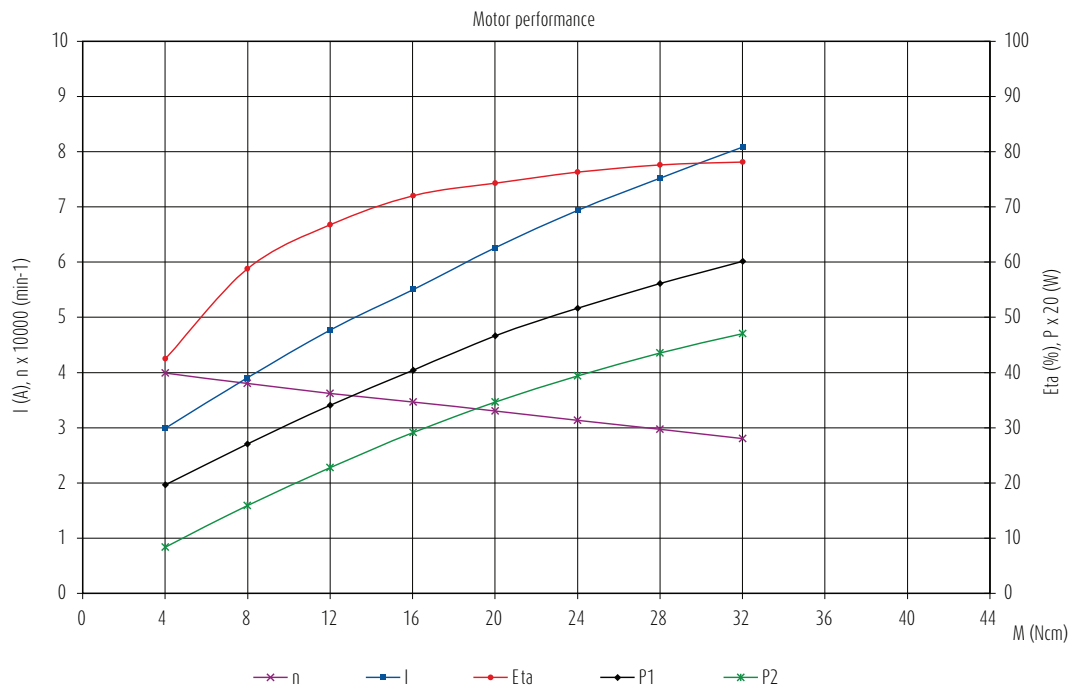

**Additional note:**

- other custom-design solutions up on your request!!