

497.3.267 & 265

145mm (5,7") Diameter – Radial (Peripheral) Discharge



Brushless motor drives with long life offer a wide range of vacuum or pressure applications. They are used for wet and dry aspiration. Blowers consist of brushless motor with integrated controller built on fan system with one to three fan stages and tangential discharge.

By using electronic drive, carbon brushes are eliminated. Main blower's functions are supervised by digital signals with high accuracy and quick response. Overall it means enhanced flexibility, high performance and high level of robustness.

Special sealing system used on floor care was designed to protect a bearing against an influence of polluted air and moisture (497.3.267). Intelligent drive is adapted to regenerate air supply of fuel cells. Main technical features are the same like in other blowers (blocked rotor protection, thermal protection, soft start, etc.) Standard models do not contain speed regulation.

In the table below are representatives of tangential low voltage blower family. Each blower includes:

- side cooling air inlet and
- working air inlet.

All other combinations such as:

- top cooling air inlet
 - top cooling air inlet with tube
 - working air inlet with tube
 - speed control 0-10VDC or PWM
- are available upon request.

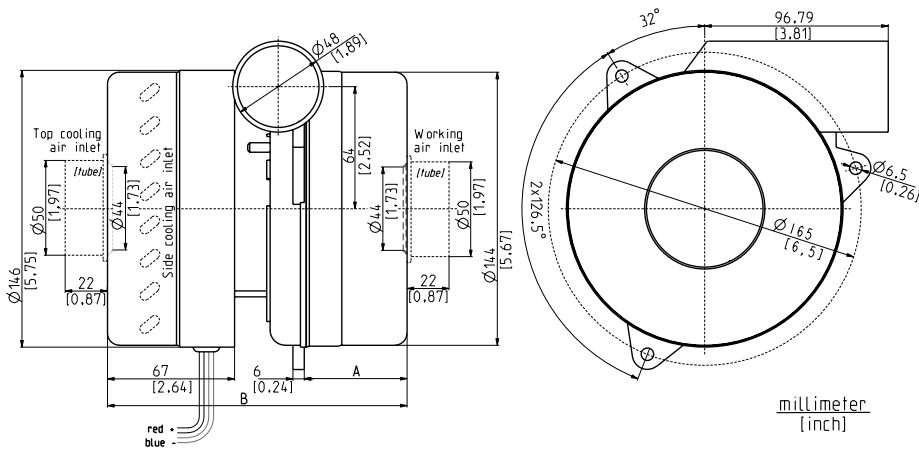

Dimensional and performance data are subject to change without notice.

Selection and ordering information for low voltage 24, 36 and 52 V DC - TANGENTIAL DISCHARGE												
Code	Curve	A		B		P1	U	Sealed Vacuum		Max. air flow		Mass
		[mm]	[in]	[mm]	[in]			[kPa]	[inH2O]	[l/s]	[CFM]	
497.3.267-10	1E36	36	1,42	141	5,55	950	36	14	56,26	55,70	118,02	2,1
497.3.267-8	2E36	54	2,13	166	6,54	1000	36	20,5	82,38	47,22	100,05	2,55
497.3.267-7	2E24	54	2,13	166	6,54	700	24	15,21	53,85	42,77	90,62	2,65
497.3.265-851	3P36	81	3,19	185	7,28	1000	36	25,4	102,07	38,88	82,38	2,1
497.3.265-853	3P52	81	3,19	185	7,28	1200	52	26,9	108,10	42,78	90,65	2,55

Data above represent the performance of an average motor sample. Individual data may vary due to normal manufacturing variations.

Various input power; Low Voltage

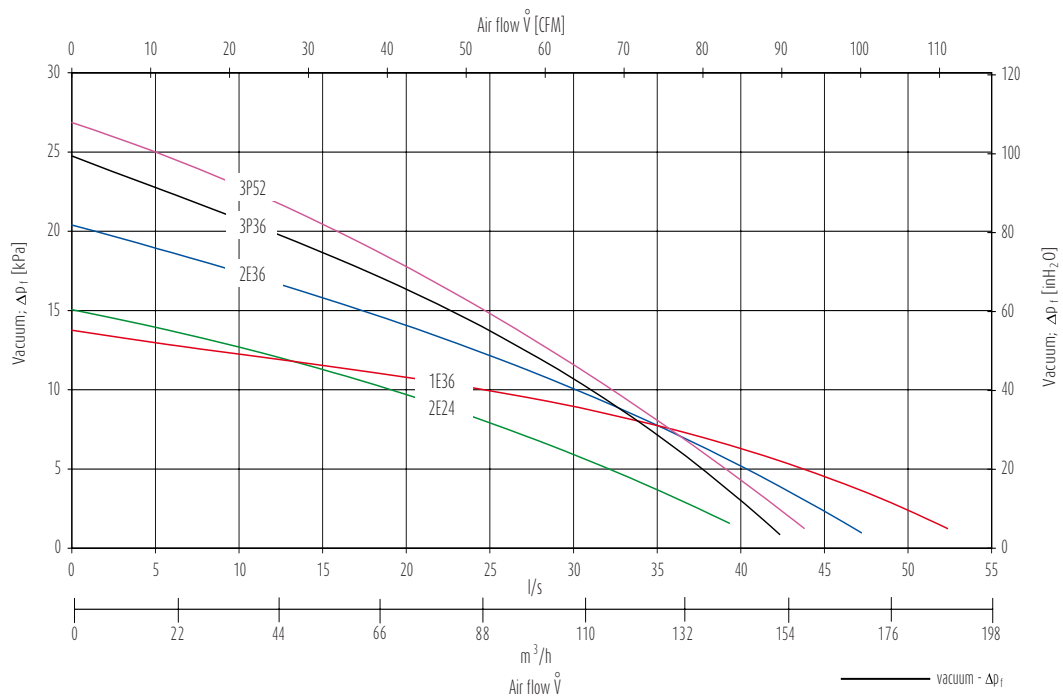

Special features:

- Water proofed sealing between blower and motor parts
- Anticorrosion and antistatic protection
- Suitable for advanced applications:
 - battery operating machines
 - scrubbers
 - extractors
 - fuel cells